



Scan the code above or visit  
[www.nwleics.gov.uk/meetings](http://www.nwleics.gov.uk/meetings) for a full copy of the  
agenda.

Meeting	<b>LICENSING SUB COMMITTEE</b>
Time/Day/Date	10.30 am on Tuesday, 21 November 2023
Location	Abbey Room, Stenson House, London Road, Coalville, LE67 3FN
Officer to contact	Democratic Services (01530 454512) Licensing Enforcement Officer (01530 454596)

### NOTIFICATION OF HEARING

Item	Pages
------	-------

<b>1</b>	<b>ELECTION OF CHAIRMAN</b>	
----------	-----------------------------	--

<b>2</b>	<b>APOLOGIES FOR ABSENCE</b>	
----------	------------------------------	--

<b>3</b>	<b>DECLARATION OF INTERESTS</b>	
----------	---------------------------------	--

Under the Code of Conduct members are reminded that in declaring interests you should make clear the nature of that interest and whether it is a disclosable pecuniary interest, registerable interest or other interest.

<b>4</b>	<b>XXX BUNS - APPLICATION FOR A NEW PREMISE LICENCE</b>	
----------	---	--

**PREMISES:** XXX Buns, 7 Bakery Court, Market Street, Ashby de la Zouch, LE65 1AN.

**3 - 48**

**APPLICANT:** Mr Anthony Haslam.

To determine an application for a new premises licence in respect of the above.

A representation has been received from Ashby Town Council. A notice of hearing inviting a representative to attend has been sent. If they fail to attend, the hearing can be held in their absence or adjourned. The following documents are attached:

- a) Report of the Licensing Enforcement Officer

At the beginning of the Hearing, the authority shall explain to the parties the procedure it is proposed to follow. The Hearing shall take the form of a

discussion led by the authority and cross-examination shall not be permitted unless it is required to consider the representations.

Circulation:

Councillor J Legrys  
Councillor G Rogers  
Councillor J G Simmons  
Councillor D Everitt (Reserve Member)

## NORTH WEST LEICESTERSHIRE DISTRICT COUNCIL

LICENSING SUB COMMITTEE – TUESDAY 21  
NOVEMBER, 2023



<b>Title of Report</b>	<b>APPLICATION FOR THE GRANT OF A PREMISES LICENCE UNDER THE LICENSING ACT 2003</b>	
<b>Presented by</b>	Paul Dennis, Licensing Enforcement Officer	
<b>Background Papers</b>	<p><a href="https://publishing.service.gov.uk">Revised Guidance issued under section 182 of the Licensing Act 2003 (publishing.service.gov.uk)</a></p> <p><a href="https://legislation.gov.uk">Licensing Act 2003 (legislation.gov.uk)</a></p> <p><a href="#">Statement of Licensing Policy – Issue 7</a></p> <p><a href="#">Cumulative Impact Assessment 2022 Ashby De La Zouch.pdf (nwleics.gov.uk)</a></p>	<b>Public Report: Yes</b>
<b>Purpose of Report</b>	<p>To determine an application for the grant of a premises licence in respect of the premises XXX Buns Limited, 7 Bakery Court, Market Street, Ashby de la Zouch, LE65 1AN.</p> <p>This report outlines the application and also highlights the licensing objectives, the relevant parts of Government guidance and the pertinent sections of the Licensing Authority's Licensing Policy.</p>	
<b>Recommendations</b>	<b>THAT THE SUB-COMMITTEE DETERMINE THE APPLICATION.</b>	

**1.0 Background**

1.1 Mr Anthony Haslam applied for the grant of a premises licence at 7 Bakery Court, Market Street, Ashby de la Zouch, LE65 1AN on 3 October 2023. The application form is attached as **Appendix 1**.

1.2 The premises plan is attached as **Appendix 2**.

- 1.3 A map of the site is attached as **Appendix 3**.
- 1.4 As part of the application, the applicant has specified the steps they intend to take in order to promote the four licensing objectives. These are as follows:

General - all licensing objectives:

(l) The licensee, that is the person in whose name the premise licence is issued, shall ensure that at all times when the premises are for any licensable activity, there are sufficient competent staff on duty at the premise for the purpose of fulfilling the terms and conditions of the licence and for preventing crime and disorder. The licensee shall ensure that all staff will undertake training in their responsibilities in relation to the sale of alcohol, particularly with regard to drunkenness and underage persons. records will be kept of training and retraining.

#### DRINKS PROMOTIONS

1. I will adopt and comply with the British Beer and Pub Associations Guidelines on On-Trade Promotions.

#### PROOF OF AGE CARDS

1. I will ensure that any person selling or supplying alcoholic drink under the authority of a personal licence holder asks for a photo ID proof of age where they have reason to suspect that the individual may be under 25 years of age.

#### CCTV & COMMUNICATION

1. I will provide a means of two way communication to report incidents between the premises and the local police or CCTV monitoring centre.

2. I will install Video/CCTV equipment inside/outside the premises and ensure that it is maintained in working order.

3. CCTV will be set to record 24 hours daily.

4. I will ensure that monitoring tapes are retained for at least twenty-eight days and are produced to an authorised officer on demand.

5. I will put up notices advising that CCTV has been installed on the premises so that they are clearly visible to the public within the licensed premises.

#### NOTICES

1. I will display any restrictions on the admittance of individuals according to age (e.g. Children) on or immediately outside the premises.

2. I will display any conditions of entry / exit, to / from the premises in the vicinity of any entrance to the premises.

## ESCAPE ROUTES

1. I will make sure that escape routes and exits, including external exits, are maintained to ensure that they are not obstructed, in good order with non-slippery and even surfaces, free of trip hazards and clearly identified.

2. I will make sure that all exit doors are easily openable and do not require the use of a key, card, code or similar means.

3. I will make sure that doors at such exits are regularly checked to ensure that they function satisfactorily and a record of the check is kept.

4. I will make sure that the edges of the treads of steps and stairways are maintained.

## RISK ASSESSMENT / SAFETY CHECKS

1. Safety checks are carried out before the admission of the public.

2. Risk assessments re evaluated and updated accordingly. logs kept in folder on site.

## FIRE ACTION

1. I will make sure that notices detailing the action to be taken in the event of fire or other emergencies, including how the fire brigade should be summoned, are prominently displayed and protected from damage and deterioration.

2. The fire brigade will be called at once to any outbreak of fire, however slight, and the details recorded in a Fire Log-book

3. I will make sure that when disabled people are present, adequate arrangements exist to enable their safe evacuation in the event of an emergency, and that patrons are made aware of these arrangements.

## FIRST AID

1. I will make sure that adequate and appropriate supply of first aid equipment and materials is available on the premises.

2. I will make sure that at least 1 trained first aider(s) will be on duty when the public are present.

## LIGHTING

1. In the absence of adequate daylight, I will make sure that the lighting in any area accessible to the public is fully operational.
2. I will make sure that Fire safety signs are adequately illuminated

#### PUBLIC LIABILITY

1. I will make sure that I have valid public liability insurance in force and that a copy of the schedule is available for inspection by an authorised officer on request.

#### GENERAL

1. I will make free drinking water available at all times the premises is open to the public.
2. I will provide a "hot line" to a local taxi firm.
3. I will display prominent, clear and legible notices at all exits requesting patrons to respect the needs of local residents and to leave the premises and the area quietly.
4. I will ensure that offensive smells from the licensed premises are not permitted so as to cause a nuisance to nearby properties and the premises are properly vented.
5. Ensure that receptacles for waste are emptied regularly to minimise nuisance smells.

The prevention of crime and disorder: Any incidents of a criminal nature that may occur on the premise will be reported Immediately to the police.

(I) The licensee will install comprehensive cctv coverage the premise and it is operated and maintained at the premise.

The CCTV shall conform to the following points:

1. Cameras must be sited to observe the entrances and exits, both inside and outside.
2. Camera on the entrances must capture full frame shots of the shoulder and heads of all people entering the premise i.e. capable of identification.
3. Camera's viewing till areas must capture frames no less than 50% of screen.
4. Camera's overlooking floor areas should be wide angled to give an overview of the premise.
5. Be capable of visually confirming the nature of the crime committed.

6. Provide a linked record of the date, time and place of any image.
7. Provide good quality images - colour during the day.
8. Have a monitor on the premise to be able to rewind, review and record any images/video.
9. Have displayed notices of 24/7 CCTV operation
10. Police will have access to any images/video at any reasonable time.
11. All digital images/videos will be recorded and kept for up to 28 days.

#### DOOR SUPERVISORS

I will use or employ door supervisors at all times when a licensable activity is being carried out and I consider them necessary to:

1. Prevent the admission and ensure the departure from the premises of drunk and disorderly persons, without causing further disorder;
2. Keep out excluded individuals (subject to court or pub watch bans)
3. Search and exclude persons suspected of carrying illegal drugs or offensive weapons; or
4. Maintain an orderly queue outside the venue.

#### OTHER

1. I shall participate in the local pubwatch / nightsafe scheme operating in the District
2. I will ensure that a secure deposit box is kept on the premises for the retention of confiscated items and ensure that the Police are advised of any items which require safe disposal.(Record will be logged and kept on the premise).

Public safety:

#### GENERAL

1. I shall ensure Appropriate Fire safety procedures are in place including fire extinguishers (foam, co2, wet chemical), fire blanket are easily accessible.
2. I shall ensure fire exit signs above all fire exits and smoke detectors are regularly maintained and easily visible. (please refer to site plan for more information regarding locations).
3. All emergency exits to be kept clear of any obstructions.

4. I shall ensure Adequate Highlighting of steps and lighting to prevent trips or falls / lack of visibility.

5. I shall ensure a Full risk assessment of the premise will be carried out and staff trained in the implementation of working safely.

6. I shall ensure All electrical equipment / Appliances are inspected annually.

7. I shall ensure all staff are regularly trained in the management of alcohol and food safety.

Records will be logged and kept on the premise.

#### BOTTLES AND GLASSES

1. Where glass bottles are used, they will be retained or disposed of on the premises.

2. No customers will be admitted, or permitted to leave when carrying open or sealed bottles or glasses.

#### RESTRICTIONS ON DRINKING AREAS

1. I will ensure that the consumption of alcohol is restricted to the areas identified on the plan attached to the operating schedule

#### DOOR SUPERVISORS

I will use or employ door supervisors at all times when a licensable activity is being carried out and I consider them necessary to:

1. Prevent the admission and ensure the departure from the premises of drunk and disorderly persons, without causing further disorder;

2. Keep out excluded individuals (subject to court or pub watch bans)

3. Search and exclude persons suspected of carrying illegal drugs or offensive weapons.

4. Maintain an orderly queue outside the venue.

#### The prevention of public nuisance: NOISE & VIBRATION

1. I will make sure that doors and windows are kept closed (except for ingress and egress) to reduce noise nuisance from the premises.

2. I will display prominent, clear and legible notices at all exits requesting patrons to respect the needs of local residents and to leave the premises and the area quietly.



3. I will make sure that the placing of bottles into receptacles outside the premises takes place at times that will minimise disturbance to nearby properties.

4. I will ensure that amplified music emitted from the premise does not exceed the recommended decibel range.

#### NOXIOUS SMELLS

1. I will ensure that offensive smells from the licensed premises are not permitted so as to cause a nuisance to nearby properties and the premises are properly vented.

2. Ensure that receptacles for waste are emptied regularly to minimise nuisance smells.

#### LIGHT POLLUTION

1. I will ensure that flashing or particularly bright lights on or outside the licensed premises do not cause a nuisance to nearby properties, whilst balancing the need for lighting in the interests of prevention of crime and disorder.

#### LITTER

1. I will make sure litter is regularly cleared from the vicinity of the premises.

2. I will make sure that receptacles for refuse storage are maintained in a clean condition

The protection of children from harm:

All staff to be trained in underage sales prevention and to strictly enforce the challenge 25 scheme. i.e. all persons who appear under 25 will be required to provide photographic ID such as passport / driving licence or other government issued photographic ID.

All refused sales will be recorded in a register and kept on the premise.

I shall ensure adequate signage stipulating No persons under 18 shall be permitted to enter the premise to be placed over the exterior of the premise.

1.5 The applicant has applied for the following licensable activities and timings.

<b>Licensable activity</b>	<b>Timings</b>	
Supply by retail of alcohol	Everyday	10:00hrs - midnight
Late night refreshment	Everyday	23:00hrs - midnight

## 2.0 Representations

- 2.1 In respect of an application for the grant of a premises licence, the applicant is responsible for advertising the application by way of a notice in specified form at the premises for not less than 28 consecutive days and in a local newspaper. The applicant placed a notice in The Ashby/Coalville Times on Friday, 6 October 2023 and officers are satisfied that the correct notices have been displayed at the premises.
- 2.2 Each of the responsible authorities have been served a copy of the application, namely; the Police, Fire Authorities, Home Office, Trading Standards Department, Health Authority and the District Council's Health and Safety, Environmental Protection and Planning sections. We have not received any representations from any of the responsible authorities.
- 2.3 Other persons are able to make representations within 28 days of display of the notice of application to the Licensing Authority. One representation was received from Ashby Town Council on the grounds of the prevention of crime and disorder, the prevention of public nuisance, public safety and the protection of children from harm. The representation is attached as **Appendix 4**.
- 2.4 Following Ashby Town Council's representation, the applicant drafted a response which is attached as **Appendix 5**.

## 3.0 Statutory Guidance

- 3.1 In making its decision, the Sub-Committee is obliged to have regard to Guidance issued by the Secretary of State under Section 182 of the Licensing Act 2003. All Licensing Committee members have been provided with a full copy of the guidance document. Officers consider that paragraphs 1.1 to 1.5, 1.13, 2.1 to 2.14, 2.20 to 2.34, 3.1 to 3.2, 3.12, 8.7 to 8.8, 8.13, 8.80, 9.1 to 9.10, 9.31 to 9.44, 10.1 to 10.10, 14.1 to 14.3, 14.20 to 14.21 may have a bearing upon the application.

## 4.0 Statement of Licensing Policy

- 4.1 The Sub-Committee is also obliged to have regard to its own Statement of Licensing Policy. Officers consider that paragraphs 1.5, 2.1 to 2.3, 2.5, 4.1 to 4.4, 5.1 to 5.4, 6.1 to 6.4, 7.1 to 7.4, 10.0, 22.0, and 26.0 may have a bearing upon the application.

## 5.0 Cumulative Impact

- 5.1 The premises are situated within the area of the special policy on cumulative impact referred to in the Council's Statement of Licensing Policy.
- 5.2 The Licensing Authority recognises that this policy cannot be absolute and will consider each application properly on its merit and those that are unlikely to contribute to the cumulative impact problems will be granted.

5.3 Where the Licensing Authority decides that an application should be refused, it will still need to show that the grant of the application would undermine the promotion of one of the licensing objectives and that appropriate conditions would be ineffective in preventing the problems involved.

## 6.0 Observations

6.1 The Committee is obliged to determine this application with a view to promoting the licensing objectives, which are:

- The prevention of crime and disorder;
- Public safety;
- The prevention of public nuisance;
- The protection of children from harm.

6.2 The Committee may take such of the following steps, if any, as it considers appropriate for the promotion of the licensing objectives:

- Grant the application and issue the premises licence as requested.
- Modify the conditions of the licence, by altering or omitting or adding to them.
- Reject the whole or part of the application.

6.3 There is a right of appeal to the Magistrates' Court against the decision of the Sub-Committee by the applicant and persons who made relevant representations.

<b>Policies and other considerations, as appropriate</b>	
Council Priorities:	Communities and housing – looking after our tenants and keeping our communities safe
Policy Considerations:	Statement of Licensing Policy – Issue 7 Cumulative Impact Assessment 2022-25
Safeguarding:	To determine the application in accordance with the Licensing Act 2003 objectives
Equalities/Diversity:	No Equality/Diversity issues raised, though this will be kept under review.
Customer Impact:	Customers may be impacted by any decision made.
Economic and Social Impact:	Not applicable
Environment and Climate Change:	Not applicable
Consultation/Community Engagement:	Leicestershire Police, Leicestershire Fire and Rescue Service, The Home Office, Trading Standards, Health and Safety, Environmental Protection, Licensing Authority, Planning, Health Authority and members of the public/local businesses by way of notice at the premises, on the Council's website.
Risks:	The risk of incurring costs arising from an appeal against the decision of the Committee. In any event and in order to mitigate these

	risks, the Committee should give clear reasons for its decisions and any such reasons would need to be substantiated in Court.
Officer Contact	Paul Dennis Licensing Enforcement Officer <a href="mailto:paul.dennis@nwleicestershire.gov.uk">paul.dennis@nwleicestershire.gov.uk</a>

# Premise Licence - XXX BUNS LTD

## Agent Details

Name: Anthony Haslam

Address: [REDACTED]

Email address: [REDACTED]

Phone numbers:

[REDACTED]

## Applicant Details

Name: ANTHONY HASLAM

Date of birth: [REDACTED]

Address: [REDACTED]  
[REDACTED]  
[REDACTED]

Contact numbers: [REDACTED]

Email address: [REDACTED]

Applicant's nationality: BRITISH

Is the applicant entitled to work in the UK: Yes

Does the Main applicant have a 'Right To Work Share Code' supplied by the Home Office?

No

Enter the 9 digit 'Right to Work Share Code';

In what capacity are you applying for the premises licence? a person other than an individual (as a limited company, as a partnership, as an unincorporated association or other, for example a statutory corporation)

Persons applying as individual(s) or persons other than individual(s), please confirm: am carrying on or proposing to carry on a business which involves the use of the premises for licensable activities

---

## Premise Details

Name of premises: XXX BUNS LTD

**Company name:** XXX BUNS LTD

**Company number:** 14750247

**Phone number of premise:** 01530648074

**Address:**

7 Bakery Court Market Street

Ashby De La Zouch

LE65 1AN

**Please give a description of the premises:** Currently a 36 Seater street food restaurant(Inclusive of a balcony area). It is located in the quiet Bakery Court of Ashby de la zouch (opposite Abbey Taxis). Its main access is via South Street. The premise also shares access via the town hall market. More details on fire exits & layout will be provided via plan of the premise.

**Non-domestic rateable value of premise:** Band B - £4,301 to £33,000

---

## Premise licence

**When do you want the premises licence to start?**31/10/2023

**Do you wish the licence to be valid for a limited period?**No

**Do you expect 5,000 or more people to attend the premises at any one time?**No

## Opening Days

**Monday:** Yes

**Opening time:** 10:00

**Closing time:** 00:00

**Tuesday:** Yes

**Opening time:** 10:00

**Closing time:** 00:00

**Wednesday:** Yes

**Opening time:** 10:00

**Closing time:** 00:00

**Thursday:** Yes

**Opening time:** 10:00

**Closing time:** 00:00

**Friday:** Yes

**Opening time:** 10:00

**Closing time:** 00:00

**Saturday:** Yes

**Opening time:**

**Closing time:**

**Sunday:** Yes

**Opening time:** 10:00

**Closing time:** 00:00

**List the times when you intend the premises to be open to the public at different times than those listed above. For example (but not exclusively), where the activity will occur on additional days during the summer months.**

none

**State any season variations for the hours the premises will be open to the public. For example (but not exclusively), where you wish the activity to go on longer on a particular day e.g. Christmas Eve.**

none

---

## **Licensable activities**

**Plays:** No

---

**Films:** No

---

**Indoor sporting events:** No

---

**Boxing or wrestling:** No

Live music No

---

**Recorded music: No**

---

**Performance of dance: No**

---

**Anything of a similar description to the above that does not fit into a single category: No**

---

**Provision of late night refreshment: Yes**

**Standard Days and Timings**

**Monday start time: 23:00**

**Monday finish time: 00 00**

**Tuesday start time: 23:00**

**Tuesday finish time: 00:00**

**Wednesday start time: 23:00**

**Wednesday finish time: 00 00**

**Thursday start time: 23:00**

**Thursday finish time: 00:00**

**Friday start time: 23:00**

**Friday finish time: 00 00**

**Saturday start time: 23:00**

**Saturday finish time: 00:00**

**Sunday start time: 23:00**

**Sunday finish time: 00 00**

**List the times when you intend to use the premises for the activities at different times than those listed above. For example (but not exclusively), where you wish the activity to go on longer on a particular day e.g. Christmas Eve.**

none

---

**Additional details of the activities**



**Where will the activities take place. Where taking place in a building or other structure please select as appropriate (indoors may include a tent).**

Indoor

**Description of the type of activity that will take place. For example the type of activity to be authorised, if not already stated, and give relevant further details, for example (but not exclusively) whether or not music will be amplified or unamplified.**

Amplified music will be played in the premise but will not exceed the stipulated decibel recommendation.

**State any seasonal variations for the activities. For example (but not exclusively), where the activity will occur on additional days during the summer months.**

none.

---

## **Supply of alcohol: Yes**

### **Standard Days and Timings**

**Monday start time: 10:00**

**Monday finish time: 00:00**

**Tuesday start time: 10:00**

**Tuesday finish time: 00:00**

**Wednesday start time: 10:00**

**Wednesday finish time: 00:00**

**Thursday start time: 10:00**

**Thursday finish time: 00:00**

**Friday start time: 10:00**

**Friday finish time: 00:00**

**Saturday start time: 10:00**

**Saturday finish time: 00:00**

**Sunday start time: 10:00**

**Sunday finish time: 00:00**

**List the times when you intend to use the premises for the activities at different times than those listed above. For example (but not exclusively), where you wish the activity to go on longer on a particular day e.g. Christmas Eve.**

none.

---

## Additional details of the activities

Where will the activities take place. Where taking place in a building or other structure please select as appropriate (indoors may include a tent).

On the premises

Please give further details of the indoor sporting event here. For example the type of activity to be authorised, if not already stated, and give relevant further details, for example (but not exclusively) whether or not music will be amplified or unamplified.

Amplified music will be played from inside the premise .

State any seasonal variations for the activities. For example (but not exclusively), where the activity will occur on additional days during the summer months.

---

## Designated Premise Supervisor

Title: Mr

First Name: ANTHONY

Surname: HASLAM

Date of birth: [REDACTED]

Age: [REDACTED]

Place of birth: BURTON UPON TRENT

Personal licence number (if known): NWL11444

Do they live within the District: Yes

Address:

[REDACTED]

[REDACTED]

[REDACTED]

Do you have the consent form signed by the individual you wish to be designated premises supervisor? Yes

---

## Licensing Objectives

General all licensing objectives (l) The licensee that is the person in whose name the premise licence is issued, shall ensure that at all times when the premises are for any licensable activity, there are sufficient competent staff on duty at the premise for the purpose of fulfilling the terms and conditions of the licence and for preventing crime and disorder. The licensee shall ensure that all staff will undertake training in their responsibilities in relation to the sale of alcohol particularly with regard to drunkenness and underage persons. records will be kept of training and retraining.

## DRINKS PROMOTIONS

1. I will adopt and comply with the British Beer and Pub Associations Guidelines on On-Trade Promotions.

## PROOF OF AGE CARDS

1. I will ensure that any person selling or supplying alcoholic drink under the authority of a personal licence holder asks for a photo ID proof of age where they have reason to suspect that the individual may be under 25 years of age.

## CCTV & COMMUNICATION

1. I will provide a means of two way communication to report incidents between the premises and the local police or CCTV monitoring centre.
2. I will install Video/CCTV equipment inside/outside the premises and ensure that it is maintained in working order.
3. CCTV will be set to record 24 hours daily.
4. I will ensure that monitoring tapes are retained for at least twenty eight days and are produced to an authorised officer on demand
5. I will put up notices advising that CCTV has been installed on the premises so that they are clearly visible to the public within the licensed premises.

## NOTICES

1. I will display any restrictions on the admittance of individuals according to age (e.g. Children) on or immediately outside the premises.
2. I will display any conditions of entry / exit, to / from the premises in the vicinity of any entrance to the premises.

## ESCAPE ROUTES

1. I will make sure that escape routes and exits including external exits, are maintained to ensure that they are not obstructed, in good order with non-slippery and even surfaces, free of trip hazards and clearly identified.
2. I will make sure that all exit doors are easily openable and do not

require the use of a key card code or similar means

3. I will make sure that doors at such exits are regularly checked to ensure that they function satisfactorily and a record of the check is kept.

4 I will make sure that the edges of the treads of steps and stairways are maintained.

## RISK ASSESSMENT / SAFETY CHECKS

1. Safety checks are carried out before the admission of the public.

2. Risk assessments re evaluated and updated accordingly. logs kept in folder on site.

## FIRE ACTION

1. I will make sure that notices detailing the action to be taken in the event of fire or other emergencies, including how the fire brigade should be summoned are prominently displayed and protected from damage and deterioration.

2. The fire brigade will be called at once to any outbreak of fire, however slight, and the details recorded in a Fire Log-book

3 I will make sure that when disabled people are present adequate arrangements exist to enable their safe evacuation in the event of an emergency, and that patrons are made aware of these arrangements.

## FIRST AID

1. I will make sure that adequate and appropriate supply of first aid equipment and materials is available on the premises

2. I will make sure that at least 1 trained first aider(s) will be on duty when the public are present.

## LIGHTING

1. In the absence of adequate daylight, I will make sure that the lighting in any area accessible to the public is fully operational.

2 I will make sure that Fire safety signs are adequately illuminated

## PUBLIC LIABILITY

1 I will make sure that I have valid public liability insurance in force and that a copy of the schedule is available for inspection by an authorised officer on request.

## GENERAL

1. I will make free drinking water available at all times the premises is open to the public.

2 I will provide a "hot line" to a local taxi firm

- 3 I will display prominent clear and legible notices at all exits requesting patrons to respect the needs of local residents and to leave the premises and the area quietly.
4. I will ensure that offensive smells from the licensed premises are not permitted so as to cause a nuisance to nearby properties and the premises are properly vented.
5. Ensure that receptacles for waste are emptied regularly to minimise nuisance smells.

The prevention of crime and disorder Any incidents of a criminal nature that may occur on the premise will be reported Immediately to the police.

(I) The licensee will install comprehensive c.c.t.v coverage the premise and it is operated and maintained at the premise.

The CCTV shall conform to the following points:

1. Cameras must be sited to observe the entrances and exits, both inside and outside.
2. Camera on the entrances must capture full frame shots of the shoulder and heads of all people entering the premise i e capable of identification
3. Camera's viewing till areas must capture frames no less than 50% of screen.
4. Camera's overlooking floor areas should be wide angled to give an overview of the premise.
5. Be capable of visually confirming the nature of the crime committed.
- 6 Provide a linked record of the date time and place of any image
7. Provide good quality images - colour during the day.
8. Have a monitor on the premise to be able to rewind, review and record any images/video.
9. Have displayed notices of 24/7 CCTV operation
- 10 Police will have access to any images/video at any reasonable time
11. All digital images/videos will be recored and kept for up to 28 days.

## DOOR SUPERVISORS

I will use or employ door supervisors at all times when a licensable activity is being carried out and I consider them necessary to:

- 1 Prevent the admission and ensure the departure from the premises of drunk and disorderly persons, without causing further disorder;
2. Keep out excluded individuals (subject to court or pub watch bans)
3. Search and exclude persons suspected of carrying illegal drugs or offensive weapons; or
4. Maintain an orderly queue outside the venue.

## OTHER

1. I shall participate in the local pubwatch / nightsafe scheme operating in the District
2. I will ensure that a secure deposit box is kept on the premises for the retention of confiscated items and ensure that the Police are advised of any items which require safe disposal.(Record will be logged and kept on the premise).

## Public safety GENERAL

1. I shall ensure Appropriate Fire safety procedures are in place including fire extinguishers (foam, co2, wet chemical), fire blanket are easily accessible.
- 2 I shall ensure fire exit signs above all fire exits and smoke detectors are regularly maintained and easily visible. (please refer to site plan for more information regarding locations).
3. All emergency exits to be kept clear of any obstructions.
4. I shall ensure Adequate Highlighting of steps and lighting to prevent trips or falls / lack of visibility
5. I shall ensure a Full risk assessment of the premise will be carried out and staff trained in the implementation of working safely.
6. I shall ensure All electrical equipment / Appliances are inspected annually.
- 7 I shall ensure all staff are regularly trained in the management of alcohol and food safety Records will be logged and kept on the premise.

## BOTTLES AND GLASSES

1. Where glass bottles are used, they will be retained or disposed of on the premises.
2. No customers will be admitted, or permitted to leave when carrying open or sealed bottles or glasses

## RESTRICTIONS ON DRINKING AREAS

- 1 I will ensure that the consumption of alcohol is restricted to the areas identified on the plan attached to the operating schedule

## DOOR SUPERVISORS

I will use or employ door supervisors at all times when a licensable activity is being carried out and I consider them necessary to:

- 1 Prevent the admission and ensure the departure from the premises of drunk and disorderly persons, without causing further disorder;
2. Keep out excluded individuals (subject to court or pub watch bans)
3. Search and exclude persons suspected of carrying illegal drugs or offensive weapons.
4. Maintain an orderly queue outside the venue.

## The prevention of public nuisance: NOISE & VIBRATION

1. I will make sure that doors and windows are kept closed (except for ingress and egress) to reduce noise nuisance from the premises.
2. I will display prominent, clear and legible notices at all exits requesting patrons to respect the needs of local residents and to leave the premises and the area quietly

3 I will make sure that the placing of bottles into receptacles outside the premises takes place at times that will minimise disturbance to nearby properties.

4. I will ensure that amplified music emitted from the premise does not exceed the recommended decibel range

#### NOXIOUS SMELLS

1 I will ensure that offensive smells from the licensed premises are not permitted so as to cause a nuisance to nearby properties and the premises are properly vented.

2. Ensure that receptacles for waste are emptied regularly to minimise nuisance smells

#### LIGHT POLLUTION

1 I will ensure that flashing or particularly bright lights on or outside the licensed premises do not cause a nuisance to nearby properties, whilst balancing the need for lighting in the interests of prevention of crime and disorder.

#### LITTER

1. I will make sure litter is regularly cleared from the vicinity of the premises

2. I will make sure that receptacles for refuse storage are maintained in a clean condition

The protection of children from harm: All staff to be trained in underage sales prevention and to strictly enforce the challenge 25 scheme i.e. all persons who appear under 25 will be required to provide photographic ID such as passport / driving licence or other government issued photographic ID.

All refused sales will be recored in a register and kept on the premise

I shall ensure adequate signage stipulating No persons under 18 shall be permitted to enter the premise to be placed over the exterior of the premise.

---

## Declaration

It is an offence under Section 158 of the Licensing Act 2003 to make a false statement in or in connection with this application. Those who make a false statement may be liable on summary conviction to a fine of any amount.

It is an offence under Section 24B of the Immigration Act 1971 for a person to work when they know or have reasonable cause to believe that they are disqualified from doing so by reason or their immigration status. Those who employ an adult without leave or who is subject to conditions as to employment will be liable to a civil penalty under Section 15 of the Immigration, Asylum and Nationality Act 2006 and pursuant to Section 21 of the same act, will be committing an offence

where they do so in the knowledge, or with reasonable cause to believe, that the employee is disqualified.

[Applicable to individual applicants only, including those in a partnership which is not a limited liability partnership] I understand I am not entitled to be issued with a licence if I do not have the entitlement to live and work in the UK (or if I am subject to a condition preventing me from doing work relating to the carrying on of a licensable activity) and that my licence will become invalid if I cease to be entitled to live and work in the UK.

The DPS named in this application form is entitled to work in the UK (and is not subject to conditions preventing him or her from doing work relating to a licensable activity) and I have seen a copy of his or her proof of entitlement to work, or have conducted an online right to work check using the Home Office online right to work checking service which confirmed their right to work.

By ticking this box, I hereby certify the information contained in this form is correct to the best of my knowledge and belief and agree to all the above statements. Ticking this box deems this form to be signed and carries the same legal obligation as a written signature. Yes

---

## Payment Details

Amount: 190

Income code: A93227|G0310|||||GEN

Fund Code: 04

VAT Code: SE

Transaction Reference: 229-3444





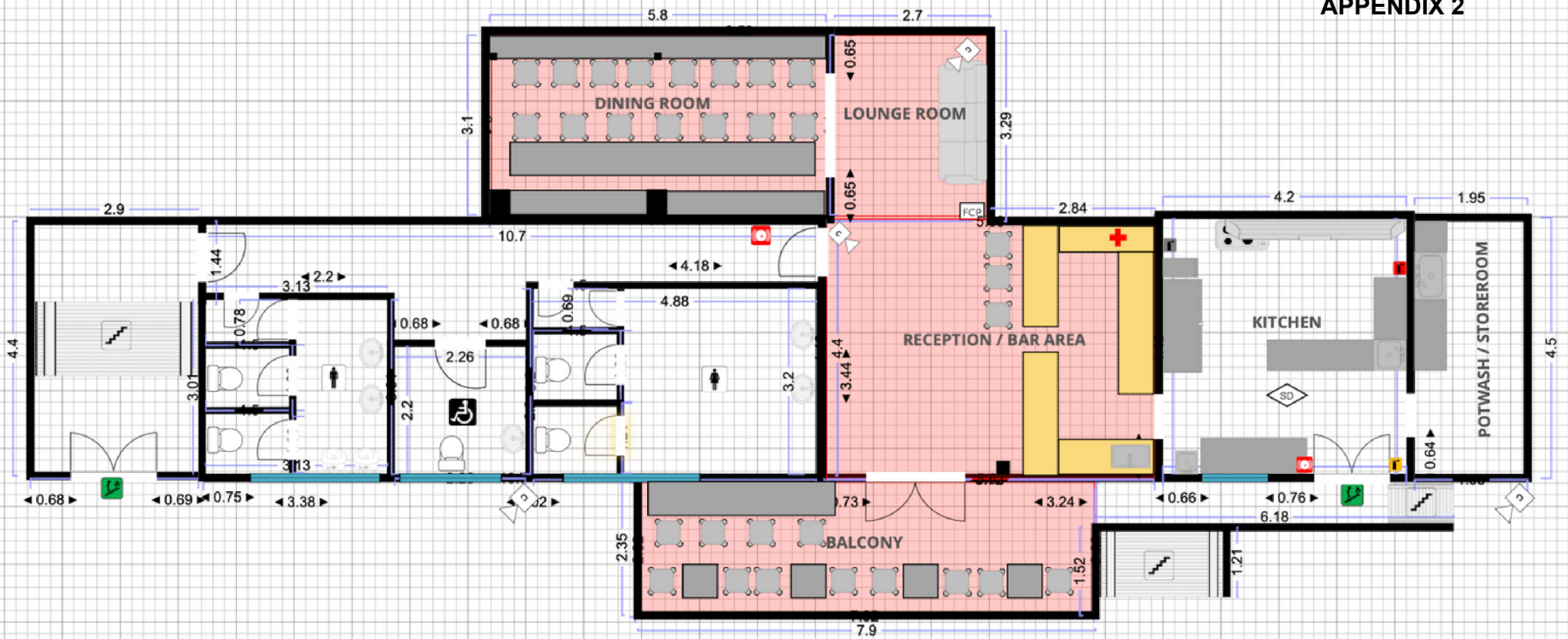

25

DRAWN BY: XXX BUNS LTD

DATE: 25/09/2023

SHEET:XXX01

SCALE: 1:100

PREMISE LICENCE FLOOR PLAN

7 BAKERY COURT

ASHBY DE LA ZOUCH

LE65 1AN

SIGNED: *Haslam*

KEY

-  FIRE EXIT
-  SMOKE DETECTOR
-  FIRE CONTROL PANEL
-  FIRE ALARM
-  FOAM EXTINGUISHER
-  CO2 EXTINGUISHER
-  WET CHEMICAL EXTINGUISHER
-  CCTV
-  WOMANS TOILET
-  MENS TOILET
-  DISABLED TOILET
-  STAIRS
-  WINDOW
-  DOOR
-  STOOL/CHAIR
-  TABLE TOP / WORKSURFACE
-  FIRST AID BOX
-  AREA FOR CONSUMPTION / SALE OF ALCOHOL & LATE NIGHT REFRESHMENT

This page is intentionally left blank

# Google Maps Ashby-de-la-Zouch



This page is intentionally left blank

**NORTH WEST LEICESTERSHIRE DISTRICT COUNCIL APPENDIX 4  
LICENSING ACT 2003**

**REPRESENTATION FORM**

<b>Your name/organisation name/name of body you represent</b>	Mel Mitchell, Deputy Town Clerk
<b>Organisation name/name of body you represent (if appropriate)</b>	Ashby de la Zouch Town Council
<b>Your Postal address</b>	LE65 1BQ
<b>Name of the premises you are making a representation about</b>	XXX Buns Ltd
<b>Address of the premises you are making a representation about</b>	7 Bakery Court, Ashby de la Zouch, LE65 1AN

<b>What are you making a representation about?</b>
Please indicate which part of the licence/certificate application you are making a representation about (i.e. Terminal hours, and music and dancing on Friday and Saturday night)
Supply by retail of alcohol everyday 10:00 to midnight, late night refreshment everyday 23:00 to midnight
The Planning and Licensing Committee of Ashby de la Zouch Town Council met on Monday 9 <sup>th</sup> October 2023 to discuss, amongst other matters, the licensing application for XXX Buns Ltd. The members of the Licensing Committee resolved to object to the application on the grounds detailed below.
The Chairman of the Committee wishes to attend before the Licensing Sub-Committee of NWLDC to make representations on behalf of the Town Council.

Your representation must relate to one of the four Licensing Objectives

<b>Licensing Objective</b>	<b>Please provide full details of your concerns regarding the application and include any evidence you may have in support of it. Please use separate sheets if necessary</b>
<b>To prevent crime and disorder</b>	As evening access to the premises, which are attached to the back of the Town Hall building, is along a small, isolated alley that connects South Street to Market Street, there is concern that this area will not have sufficient security and the presence of licensed premises, with outside drinking permitted on a terrace area, is likely to increase crime in the area. The applicant states that door security staff will only be provided , <i>“where I consider them necessary”</i> . This is wholly inadequate as security will rely upon the subjective judgement of the licensee.  We would draw attention the fact that the application premises lie at the centre of the Ashby Cumulative Impact Zone (CIZ), where <i>“the number of premises licences and club premises certificates are such that it is likely that granting further licences or variations to existing premises licences and/or club premises certificates would be inconsistent with our duty to promote the licensing objectives”</i> . The CIZ was reviewed and renewed very recently (February 2022) with full police backing.
<b>Public safety</b>	The courtyard access to the premises is shared by a taxi firm with poorly defined discrimination between pedestrians and vehicles. Currently taxi vehicles have to reverse in or out of their parking spaces which is likely to lead to collisions with pedestrians accessing and leaving the licensed premises.

<b>To prevent public nuisance</b>	There is currently just one takeaway establishment on Bakery Court, meaning customers arrive and depart relatively quickly. This application is a restaurant and is proposing both indoor and outdoor seating meaning a significant increase in noise in the area from customers dining in and outside the establishment. The noise is likely to be heard by inhabitants of town centre dwellings, particularly premises that back on to, and are situated, on South Street (South Street consisting of predominantly residential dwellings).
<b>To protect children from harm</b>	There is a gym/boxing club situated on Bakery Court directly next door to these premises that provides exercise and training for children of all ages, many of whom gather outside the gym, beside the application premises outside balcony, before and after their training sessions. The Committee is concerned that children using gym will be subject to inappropriate comments & language from intoxicated customers of XXX Buns Ltd with the possibility of more severe harm.

<b>Please suggest any conditions that could be added to the licence to remedy your representation or other suggestions you would like the Licensing Sub Committee to take into account.</b>	Limit alcohol licence to daytime only.
---	--

Signed: Melanie Mitchell

Date: 23<sup>rd</sup> October 2023

Capacity: Deputy Town Clerk (prepared on behalf of Ashby de la Zouch Town Council)

**NOT FOR PUBLICATION**

<b>Your e-mail address</b>	deputytownclerk@ashbytowncouncil.gov.uk
<b>Your contact telephone number</b>	01530 416961

**SUPPORTING NOTES**

If you do make a representation you will be invited to attend a meeting of the Licensing sub Committee and any subsequent appeal proceeding. If you do not attend, the Committee will consider any representations that you have made.

This form must be returned within the Statutory Period, which is 28 days from the date the notice was displayed on the premises or the date specified in the Public Notice in the newspaper. Please contact the Licensing Section on 01530 454556 if you are in doubt about the date.

They can only relate to the four licensing objectives.

Your representation will be passed to the applicant, to allow them the opportunity of addressing your concerns. Your representations will be published in the report available to the Licensing Sub-Committee, which will be publicly available. Names and addresses will only be withheld from the Sub-Committee report at your request. Email addresses and contact telephone numbers will not be publicly available.

Please return this form when completed along with any additional sheets to:

Community Services  
Licensing  
North West Leicestershire District Council  
Council Offices  
Coalville  
Leicestershire  
LE67 3FJ

email to [licensing@nwleicestershire.gov.uk](mailto:licensing@nwleicestershire.gov.uk)

Tel: 01530 454545  
Fax: 01530 454574

Crime in Ashby - Police.UK

	2021												2021 Total	2022						2022 Total
	Jan	Feb	Mar	Apr	May	Jun	Jul	Aug	Sep	Oct	Nov	Dec		Jan	Feb	Mar	Apr	May	Jun	
<b>On or near Bath Grounds</b>	0	1	0	0	0	1	0	0	0	0	0	0	2	0	0	2	0	0	2	4
Anti-social behaviour	0	1	0	0	0	0	0	0	0	0	0	0	1	0	0	1	0	0	0	1
Burglary	0	0	0	0	0	0	0	0	0	0	0	0	0	0	0	0	0	0	2	2
Criminal damage and arson	0	0	0	0	0	1	0	0	0	0	0	0	1	0	0	1	0	0	0	1
<b>On or near Bath Street</b>	2	2	1	7	8	14	6	15	19	23	7	10	114	11	6	9	5	11	8	50
Anti-social behaviour	0	0	0	1	2	0	0	0	1	0	0	0	4	0	1	0	0	1	0	2
Criminal damage and arson	0	0	0	0	1	0	0	0	0	1	1	2	5	0	0	0	0	0	1	1
Drugs	0	0	0	0	1	0	0	0	1	1	1	4	8	0	0	0	0	1	0	1
Other crime	0	0	0	0	0	0	0	1	1	0	1	0	3	0	0	0	0	0	0	0
Other theft	0	0	0	0	0	2	0	0	3	2	0	0	7	1	1	0	1	1	0	4
Possession of weapons	0	0	0	0	0	0	0	0	0	0	0	0	0	0	0	1	0	0	1	2
Public order	0	1	0	2	0	2	2	8	4	5	1	2	27	3	1	1	2	2	1	10
Robbery	0	1	0	0	0	1	0	0	0	0	0	0	2	0	0	1	0	1	1	3
Shoplifting	0	0	0	0	0	0	0	0	0	0	0	0	0	0	0	0	0	0	2	2
Theft from the person	1	0	0	0	0	0	0	0	1	0	0	0	2	0	0	0	0	0	1	1
Vehicle crime	0	0	0	0	0	1	0	0	0	1	0	0	2	0	0	1	0	0	0	1
Violence and sexual offences	1	0	1	4	4	8	4	6	8	13	3	2	54	7	3	5	2	5	1	23
<b>On or near Brook Street Parking</b>	1	1	0	1	0	2	2	0	3	1	4	1	16	2	1	2	0	2	1	8
Anti-social behaviour	0	0	0	0	0	0	0	0	0	0	0	0	0	1	0	1	0	0	0	2
Burglary	0	0	0	0	0	1	0	0	1	0	1	0	3	0	0	0	0	0	0	0
Criminal damage and arson	0	0	0	0	0	0	0	0	0	0	0	0	0	0	1	0	0	0	1	2
Drugs	0	0	0	0	0	0	0	0	0	0	0	0	0	0	0	0	0	1	0	1
Other theft	0	0	0	1	0	1	1	0	2	0	1	0	6	0	0	1	0	0	0	1
Public order	0	0	0	0	0	0	0	0	0	0	2	0	2	0	0	0	0	0	0	0
Shoplifting	1	1	0	0	0	0	1	0	0	0	0	1	4	0	0	0	0	1	0	1
Violence and sexual offences	0	0	0	0	0	0	0	0	0	1	0	0	1	1	0	0	0	0	0	1
<b>On or near Derby Road</b>	1	2	2	4	4	0	1	0	0	2	0	1	17	2	0	3	2	0	3	10
Anti-social behaviour	0	0	1	0	2	0	1	0	0	0	0	0	4	0	0	0	0	0	0	0
Criminal damage and arson	0	0	0	2	1	0	0	0	0	0	0	0	3	1	0	0	0	0	0	1



Other theft	0	0	0	0	0	0	0	0	0	0	0	0	0	0	0	0	1	0	0	1
Public order	0	0	0	0	1	0	0	0	0	0	0	0	1	0	0	1	0	0	0	1
Shoplifting	0	0	0	0	0	0	0	0	0	2	0	0	2	1	0	2	1	0	1	5
Theft from the person	0	1	0	0	0	0	0	0	0	0	0	0	1	0	0	0	0	0	0	0
Vehicle crime	0	1	0	0	0	0	0	0	0	0	0	0	1	0	0	0	0	0	0	0
Violence and sexual offences	1	0	1	2	0	0	0	0	0	0	0	1	5	0	0	0	0	0	2	2
<b>On or near Elford Street</b>	<b>0</b>	<b>0</b>	<b>0</b>	<b>1</b>	<b>1</b>	<b>0</b>	<b>1</b>	<b>0</b>	<b>0</b>	<b>3</b>	<b>0</b>	<b>0</b>	<b>6</b>	<b>1</b>	<b>0</b>	<b>0</b>	<b>0</b>	<b>0</b>	<b>0</b>	<b>1</b>
Criminal damage and arson	0	0	0	0	0	0	0	0	0	1	0	0	1	0	0	0	0	0	0	0
Other theft	0	0	0	0	0	0	1	0	0	0	0	0	1	0	0	0	0	0	0	0
Possession of weapons	0	0	0	0	0	0	0	0	0	0	0	0	0	1	0	0	0	0	0	1
Public order	0	0	0	1	0	0	0	0	0	0	0	0	1	0	0	0	0	0	0	0
Shoplifting	0	0	0	0	1	0	0	0	0	0	0	0	1	0	0	0	0	0	0	0
Violence and sexual offences	0	0	0	0	0	0	0	0	0	2	0	0	2	0	0	0	0	0	0	0
<b>On or near Hood Park Parking</b>	<b>2</b>	<b>0</b>	<b>0</b>	<b>0</b>	<b>0</b>	<b>0</b>	<b>0</b>	<b>3</b>	<b>0</b>	<b>0</b>	<b>2</b>	<b>0</b>	<b>7</b>	<b>0</b>	<b>1</b>	<b>2</b>	<b>0</b>	<b>1</b>	<b>0</b>	<b>4</b>
Anti-social behaviour	1	0	0	0	0	0	0	0	0	0	0	0	1	0	1	1	0	0	0	2
Burglary	0	0	0	0	0	0	0	1	0	0	0	0	1	0	0	0	0	0	0	0
Other theft	0	0	0	0	0	0	0	0	0	0	1	0	1	0	0	1	0	0	0	1
Public order	1	0	0	0	0	0	0	0	0	0	0	0	1	0	0	0	0	1	0	1
Violence and sexual offences	0	0	0	0	0	0	0	2	0	0	1	0	3	0	0	0	0	0	0	0
<b>On or near Market Street</b>	<b>1</b>	<b>0</b>	<b>1</b>	<b>0</b>	<b>5</b>	<b>3</b>	<b>5</b>	<b>7</b>	<b>10</b>	<b>13</b>	<b>6</b>	<b>5</b>	<b>56</b>	<b>6</b>	<b>11</b>	<b>6</b>	<b>8</b>	<b>6</b>	<b>10</b>	<b>47</b>
Anti-social behaviour	0	0	0	0	0	0	0	0	0	1	0	0	1	0	0	0	0	0	0	0
Burglary	0	0	0	0	0	0	0	0	0	0	0	0	0	0	1	0	0	0	0	1
Criminal damage and arson	0	0	0	0	0	1	0	0	1	0	0	0	2	1	2	0	1	0	2	6
Other crime	0	0	0	0	0	0	0	0	1	0	0	0	1	0	0	0	0	0	0	0
Other theft	0	0	0	0	0	0	0	2	0	2	3	1	8	0	1	0	2	0	2	5
Public order	0	0	1	0	2	1	1	1	2	0	1	1	10	1	1	1	0	1	2	6
Shoplifting	1	0	0	0	1	0	0	1	0	1	0	0	4	0	0	0	0	0	0	0
Theft from the person	0	0	0	0	1	0	0	0	0	0	0	0	1	0	0	0	1	0	0	1
Violence and sexual offences	0	0	0	0	1	1	4	3	6	9	2	3	29	4	6	5	4	5	4	28
<b>On or near Mill Bank</b>	<b>0</b>	<b>0</b>	<b>0</b>	<b>0</b>	<b>0</b>	<b>0</b>	<b>0</b>	<b>0</b>	<b>0</b>	<b>0</b>	<b>0</b>	<b>0</b>	<b>0</b>	<b>1</b>	<b>1</b>	<b>0</b>	<b>1</b>	<b>0</b>	<b>0</b>	<b>3</b>
Violence and sexual offences	0	0	0	0	0	0	0	0	0	0	0	0	0	1	1	0	1	0	0	3
<b>On or near North Street</b>	<b>0</b>	<b>0</b>	<b>1</b>	<b>1</b>	<b>0</b>	<b>0</b>	<b>0</b>	<b>0</b>	<b>1</b>	<b>0</b>	<b>3</b>	<b>1</b>	<b>7</b>	<b>0</b>	<b>1</b>	<b>4</b>	<b>0</b>	<b>1</b>	<b>0</b>	<b>6</b>

Anti-social behaviour	0	0	1	0	0	0	0	0	0	0	1	0	2	0	0	0	0	0	0	0
Criminal damage and arson	0	0	0	0	0	0	0	0	0	0	0	0	0	0	0	0	0	1	0	1
Other theft	0	0	0	0	0	0	0	0	0	0	0	1	1	0	0	0	0	0	0	0
Public order	0	0	0	0	0	0	0	0	0	0	0	0	0	0	0	1	0	0	0	1
Vehicle crime	0	0	0	0	0	0	0	0	0	0	0	0	0	0	0	1	0	0	0	1
Violence and sexual offences	0	0	0	1	0	0	0	0	1	0	2	0	4	0	1	2	0	0	0	3
<b>On or near North Street (Top)</b>	<b>0</b>	<b>0</b>	<b>4</b>	<b>5</b>	<b>1</b>	<b>3</b>	<b>6</b>	<b>1</b>	<b>6</b>	<b>2</b>	<b>0</b>	<b>2</b>	<b>30</b>	<b>2</b>	<b>5</b>	<b>5</b>	<b>1</b>	<b>4</b>	<b>6</b>	<b>23</b>
Burglary	0	0	0	0	0	1	0	0	0	0	0	0	1	1	0	0	0	0	0	1
Criminal damage and arson	0	0	1	0	0	0	0	0	1	0	0	0	2	0	1	0	0	1	0	2
Drugs	0	0	0	0	0	1	0	0	2	0	0	0	3	0	0	0	0	0	0	0
Other theft	0	0	0	0	0	0	0	0	0	0	0	0	0	0	1	0	0	1	0	2
Public order	0	0	0	2	0	0	0	0	0	0	0	0	2	1	0	1	0	0	0	2
Violence and sexual offences	0	0	3	3	1	1	6	1	3	2	0	2	22	0	3	4	1	2	6	16
<b>On or near North Street Parking</b>	<b>0</b>	<b>0</b>	<b>1</b>	<b>1</b>	<b>3</b>	<b>1</b>	<b>0</b>	<b>0</b>	<b>0</b>	<b>1</b>	<b>0</b>	<b>0</b>	<b>7</b>	<b>1</b>	<b>0</b>	<b>3</b>	<b>0</b>	<b>2</b>	<b>2</b>	<b>8</b>
Anti-social behaviour	0	0	1	0	1	0	0	0	0	0	0	0	2	0	0	1	0	0	0	1
Criminal damage and arson	0	0	0	0	1	0	0	0	0	0	0	0	1	0	0	0	0	0	0	0
Other theft	0	0	0	0	1	0	0	0	0	0	0	0	1	0	0	0	0	0	0	0
Public order	0	0	0	0	0	0	0	0	0	0	0	0	0	1	0	1	0	0	0	2
Violence and sexual offences	0	0	0	1	0	1	0	0	0	1	0	0	3	0	0	1	0	2	2	5
<b>On or near South Street</b>	<b>2</b>	<b>0</b>	<b>0</b>	<b>0</b>	<b>0</b>	<b>1</b>	<b>0</b>	<b>0</b>	<b>0</b>	<b>0</b>	<b>0</b>	<b>0</b>	<b>3</b>	<b>0</b>	<b>0</b>	<b>0</b>	<b>0</b>	<b>1</b>	<b>0</b>	<b>1</b>
Criminal damage and arson	0	0	0	0	0	1	0	0	0	0	0	0	1	0	0	0	0	0	0	0
Other crime	1	0	0	0	0	0	0	0	0	0	0	0	1	0	0	0	0	0	0	0
Public order	0	0	0	0	0	0	0	0	0	0	0	0	0	0	0	0	0	1	0	1
Violence and sexual offences	1	0	0	0	0	0	0	0	0	0	0	0	1	0	0	0	0	0	0	0
<b>On or near South Street (Top)</b>	<b>0</b>	<b>3</b>	<b>0</b>	<b>3</b>	<b>0</b>	<b>0</b>	<b>0</b>	<b>0</b>	<b>3</b>	<b>0</b>	<b>0</b>	<b>0</b>	<b>9</b>	<b>0</b>	<b>0</b>	<b>1</b>	<b>0</b>	<b>1</b>	<b>1</b>	<b>3</b>
Anti-social behaviour	0	1	0	0	0	0	0	0	0	0	0	0	1	0	0	0	0	0	0	0
Burglary	0	1	0	0	0	0	0	0	0	0	0	0	1	0	0	0	0	0	0	0
Criminal damage and arson	0	0	0	3	0	0	0	0	1	0	0	0	4	0	0	0	0	0	1	1
Other theft	0	0	0	0	0	0	0	0	0	0	0	0	0	0	0	1	0	0	0	1
Public order	0	1	0	0	0	0	0	0	1	0	0	0	2	0	0	0	0	1	0	1
Violence and sexual offences	0	0	0	0	0	0	0	0	1	0	0	0	1	0	0	0	0	0	0	0
<b>On or near South Street Parking</b>	<b>1</b>	<b>1</b>	<b>1</b>	<b>0</b>	<b>0</b>	<b>1</b>	<b>0</b>	<b>1</b>	<b>0</b>	<b>0</b>	<b>0</b>	<b>2</b>	<b>9</b>	<b>3</b>	<b>2</b>	<b>6</b>	<b>3</b>	<b>4</b>	<b>0</b>	<b>18</b>

Anti-social behaviour	0	0	0	0	0	1	0	0	0	0	0	0	1	0	0	1	0	0	0	1
Criminal damage and arson	0	0	0	0	0	0	0	0	0	0	1	0	1	1	0	1	0	0	0	2
Other crime	1	0	0	0	0	0	0	0	0	0	0	0	1	0	0	0	0	0	0	0
Other theft	0	1	0	0	0	0	0	1	0	0	0	0	2	0	1	0	0	0	0	1
Public order	0	0	0	0	0	0	0	0	0	0	0	0	0	0	0	1	0	0	0	1
Vehicle crime	0	0	1	0	0	0	0	0	0	0	0	0	1	0	0	0	0	0	0	0
Violence and sexual offences	0	0	0	0	0	0	0	0	0	0	1	2	3	2	1	3	3	4	0	13
<b>On or near The Green</b>	<b>0</b>	<b>0</b>	<b>0</b>	<b>2</b>	<b>1</b>	<b>1</b>	<b>0</b>	<b>0</b>	<b>3</b>	<b>2</b>	<b>1</b>	<b>0</b>	<b>10</b>	<b>1</b>	<b>2</b>	<b>0</b>	<b>1</b>	<b>1</b>	<b>1</b>	<b>6</b>
Anti-social behaviour	0	0	0	0	0	0	0	0	0	0	0	0	0	0	0	0	0	1	0	1
Criminal damage and arson	0	0	0	1	0	0	0	0	0	1	0	0	2	0	0	0	0	0	0	0
Other theft	0	0	0	0	0	0	0	0	1	0	0	0	1	0	0	0	0	0	0	0
Public order	0	0	0	1	0	1	0	0	2	1	1	0	6	1	0	0	1	0	0	2
Violence and sexual offences	0	0	0	0	1	0	0	0	0	0	0	0	1	0	2	0	0	0	1	3
<b>Grand Total</b>	<b>10</b>	<b>10</b>	<b>11</b>	<b>25</b>	<b>23</b>	<b>27</b>	<b>21</b>	<b>27</b>	<b>45</b>	<b>47</b>	<b>25</b>	<b>22</b>	<b>293</b>	<b>30</b>	<b>30</b>	<b>43</b>	<b>21</b>	<b>34</b>	<b>34</b>	<b>192</b>



To Whom this may concern,

I understand some concerns have been raised in regards to;

New premise licence - 23/00834/PREM

In this document I have addressed all concerns raised individually to the fullest of detail.

I hope this information finds you and any other persons concerned, helpful in regards to having a more thorough understanding of agreements with local business and residents, Premise position, Layout and its effects on the local neighbours, The business's legitimacy in regards to providing a fun, **safe** place for all to enjoy themselves.

I would like to start by addressing the obvious & that is before anything, we are a food establishment irregardless of our decor and theme.

In which I have applied for a premise licence for the sale of alcohol and late night refreshment it is not to attempt to solely become a Bar or nightclub but rather be able to offer an alcoholic beverage to customers when dining with us.

Please read the following below to have your concerns addressed.

Company Name: XXX BUNS LTD

APPLICATION REF: 23/00834/PREM

PREMISE LICENCE APPLICATION CONCERNS ADDRESS DOC.1

PERSON(S) LISTED WITH CONCERNS:

ASHBY TOWN COUNCIL MEMBER(S)

CONCERNS RAISED

- CRIME & DISORDER
- PUBLIC HARM
- HARM TO CHILDREN (SPECIFICALLY DUE THE A NEIGHBOURING GYM)
- NOISE & NUISANCE TO NEAR BY RESIDENCE

NOTE \* All objectives listed below are in addition to the objectives already given in the premise licence application.

**CONCERN #1 TO PREVENT CRIME & DISORDER**

Representation made -

As evening access to the premises, which are attached to the back of the Town Hall building, is along a small, isolated alley that connects South Street to Market Street, there is concern that this area will not have sufficient security and the presence of licensed premises, with outside drinking permitted on a terrace area, is likely to increase crime in the area. The applicant states that door security staff will only be provided, "when i deem necessary" . This is wholly inadequate as security will rely upon the subjective judgement of the licensee.

We would draw attention the fact that the application premises lie at the centre of the Ashby Cumulative Impact Zone (CIZ), where *"the number of premises licences and club premises certificates are such that it is likely that granting further licences or variations to existing premises licences and/or club premises certificates would be inconsistent with our duty to promote the licensing objectives"*. The CIZ was reviewed and renewed very recently (February 2022) with full police backing.

## **ADRESS #1 PREVENTION OF CRIME & DISORDER**

**'I would like to being addressing the quote from my application where it was quoted to have supposedly mentioned "where i deem necessary" in regards to door supervision.**

**This is incorrect and gives a false impression of how I the licensee intend to implement and uphold safe licensing objectives.**

**The true representation of what was mentioned on the licence application stated;**

**"I will use or employ door supervisors at all times when a licensable activity is carried out and i consider them necessary to:**

**1.Prevent the admission and ensure the departure from the premises of drunk and disorderly persons, without causing further disorder.**

**2.Keep out excluded individuals (subject to court or pub watch bans).**

**3.Search and exclude persons suspected of carrying illegal drugs or offensive weapons."**

**Further more, suggesting an increase of Crime and disorder in the area due to an exterior terrace in which only 15 person(s) can consume food and drink at one time, I find rather inadequate and rather choosy given our neighbour Lounges uk limited, has been granted approval for consumption of alcohol & late night refreshment, inside their premise and externally on the high street / rear garden everyday, between the hours of 10:00am - 12:30am.**

**Therefore I struggle to find reasoning as to why CIZ has been mentioned (please find map of CIZ attached), When other recent applicants within the CIZ area have had no concern with regards to their application.'**



Part 4  
Below is a map showing the cumulative impact zone.

Objectives that will be met to prevent crime and disorder in the locality of the area in which the licensee has applied.

**1. CCTV**

- CLOSED NETWORK CCTV WILL OPERATE 24/7 COVERING ALL ANGLES OF THE INTERIOR AND EXTERIOR OF THE PREMISES.
- CCTV WILL RECORD DAILY FOR THE PURPOSE OF BEING ABLE TO GO BACK TO A SPECIFIC EVENT IF NEEDED AND BE HELD ON THE PREMISE FOR UP TO 30 DAYS.
- IF NEEDED, AT ANY POINT THE LOCAL AUTHORITIES CAN AND WILL BE GIVEN ACCESS TO CCTV FOOTAGE.
- CCTV WILL OPERATE IN CLEAR LIGHT, COLOUR & SOUND.
- CCTV CAMERA'S WILL BE ANGLED TO EASILY CAPTURE A PERSONS PROFILE AND FACE.

**2. DOOR SUPERVISORS**

- ACCREDITED & CERTIFIED DOOR SUPERVISORS WILL BE HIRED FOR THE DUTIES OF ENSURING SAFE CONDUCT WITHIN / OFF THE SURROUNDING PREMISE.
- DOOR SUPERVISORS WILL ENSURE ANY/ALL GLASSES ARE KEPT ON THE PREMISE & ALL ALCOHOL TO BE CONSUMED WITHIN THE RED AREAS HIGHLIGHTED IN THE PREMISE PLAN.
- DOOR SUPERVISORS TO BE CERTIFIED / TRAINED IN THE SAFE DE-ESCALATION OF SITUATIONS.
- DOOR SUPERVISORS WILL ENSURE ALL PERSONS ATTENDING ARE CHALLENGED USING THE THE CHALLENGE 25 SCHEME.
- DOOR SUPERVISORS WILL ENSURE THE REFUSAL OF ANY DRUNKEN PERSONS.
- DOOR SUPERVISORS WILL ENSURE EVERY PERSON IS FREE FROM ILLICIT DRUGS / WEAPONS. PERSONS CAUGHT WITH ANY ILLICIT DRUGS / WEAPONS WILL HAVE THEM IMMEDIATELY CONFISCATED AND PLACED INTO A LOCK SAFE & THE PERSONS WILL BE REPORTED TO AUTHORITIES. UNTIL THE AUTHORITIES ARRIVE TO SAFELY DISPOSE AND DEAL WITH SITUATION.

- DOOR SUPERVISORS WILL BE IN ATTENDANCE ON THE PREMISE DURING OPENING HOURS ACCORDING TO THE CONFIRMED OPERATING SCHEDULE.
- DOOR SUPERVISORS WILL HAVE ALL TRAINING AND LICENCE'S NEEDED FOR THE ROLE AND COPIES OF CERTIFICATION WILL BE KEPT ON THE PREMISE .

3. **PUB WATCH**

- LICENSEE SHALL ATTEND AND REPORT ACCORDINGLY TO THE LOCAL PUB WATCH SCHEME TO REMAIN UP TO DATE.

4. **VERTICAL DRINKING**

- ALL CUSTOMERS TO REMAIN SEATED WITH ALCOHOL.

5. **SAFE DRINKING**

- ALL ALCOHOL SERVINGS TO BE MEASURED ACCORDING TO GOVERNMENT RECOMMENDATIONS
- ALL/ANY DRINKS PROMOTIONS WILL BE ACCOMPANIED WITH FOOD ITEMS.

6. **SAFE TAXI SCHEME**

- WE & ABBEY TAXI'S HAVE PARTNERED IN THE EVENT A CUSTOMER IS VISIBLY CONCERNED ABOUT HOW TO GET HOME SAFE, WE ENSURE TAXI SERVICES ARE AVAILABLE AND IN THE EVENT THE PERSONS CONCERNED CANNOT AFFORD THEIR FARE WE SHALL PROVIDE UP TO £10.00 TOWARDS THEIR JOURNEY COST AND ANY OTHER AMOUNT CAN BE PAID BACK AT A LATER DATE TO THE TAXI RANK PROVIDED WITH THE PERSONS INFORMATION.

7. **STAFF TRAINING**

- ALL STAFF TO RECEIVE FULL THOROUGH TRAINING IN THE FOLLOWING;

- WORKPLACE SAFETY
- SAFE HANDLING OF ALCOHOL
- CHALLENGE 25 SCHEME
- LOGGING OF ALCOHOL REFUSAL
- DEALING WITH DRUNKENNESS
- REPORTING ISSUES AS THEY HAPPEN
- RISK ASSESSING / RISK MANAGEMENT

ALL STAFF TRAINING SHALL BE RECORDED AND KEPT LOGGED ON SITE

**CONCERN #2 PUBLIC SAFETY**

Representations made -

The courtyard access to the premises is shared by a taxi firm with poorly defined discrimination between pedestrians and vehicles. Currently taxi vehicles have to reverse in or out of their parking spaces which is likely to lead to collisions with pedestrians accessing and leaving the licensed premises.



## ADDRESS CONCERN #2

'Please refer to the map diagram below which shows the courtyard in question, XXX BUNS LTD premises location in comparison to ABBEY TAXI'S, inclusive of a key to further help identify vehicle / pedestrian walkways or roads.



7 BAKERY COURT LE65 1AN SITE PLAN



Map area bounded by: 435845.316491 435935.316781. Produced on 01 March 2022 from the OS National Geographic Database. Reproduction in whole or part is prohibited without the prior permission of Ordnance Survey. © Crown copyright 2022. Supplied by UKPlanningMaps.com a licensed OS partner (100054135). Unique plan reference: b90c/uk/760461/1028718

Note\* Unit 5 corresponds to Abbey Taxi's.

**I would also like to add that we care about and work closely with our neighbours Abbey Taxi's, La Spezia Pizzeria, Motiv 8 Gym, The Market Stall Holders & Meraki to ensure no hinderance to either parties in regards to operating our business's and all agree on decisions in regards to safe use of the courtyard.**

**\*I have attached signed Letters of approval from all the listed parties above.**

**Customers can also enter the premise via the town hall market but is limited to between the hours of 10:00am - 16:00pm at which point the Town Hall Market will close and access will have to be gained via Bakery Court."**

Additional Objectives to prevent public harm.

1. DOOR SUPERVISORS WILL ACTIVELY HINDER ANY LOITERERS AND ANTI SOCIAL BEHAVIOUR FROM TAKING PLACE AROUND THE IMMEDIATE VICINITY OF THE PREMISES.

2. ABBEY CARS, XXX BUNS LTD AND LA SPEZIA PIZZERIA ALL AGREE ON A PLAN FOR SAFE USE OF THE COURTYARD DURING OPENING / OPERATING TIMES.
3. CLEARLY DEFINED LINES TO REPRESENT TAXI SPACES

### **CONCERN #3 NOISE & NUISANCE TO NEAR BY RESIDENTS**

Representations made -

There is currently just one takeaway establishment on Bakery Court, meaning customers arrive and depart relatively quickly. This application is a restaurant and is proposing both indoor and outdoor seating meaning a significant increase in noise in the area from customers dining in and outside the establishment. The noise is likely to be heard by inhabitants of town centre dwellings, particularly premises that back on to, and are situated, on South Street (South Street consisting of predominantly residential dwellings).

### **ADDRESS #3 NOISE AND NUISANCE TO NEAR BY RESIDENTS**

**“Regarding Noise and nuisance, The business has currently been operating for around 6 weeks, and yet to receive any formal complaint with regards to noise levels or disturbances to near by residence or other.**

**During this 6 weeks period we have had customers both inside and on the exterior terrace with amplified music played from the hours of 17:00pm - 22:30pm (Current Business Operating Schedule). 0 complaints.**

**We are also surrounded by multiple Nightclubs and Pubs (please refer to detailed map below) that ONLY offer Alcohol & live / pre recorded music at levels which can be heard from the majority of residence in the town.**

**That being said I find it somewhat hard to believe that it has been suggested that our small Food Establishment will cause disturbance to the local residence, in comparison to the already heard & soon to be heard licensed business's existing in the town's centre.**

**I have also gone out and personally spoke to residents along south street in regards to your concerns and not one resident can confirm of any disturbance from our premise in comparison to those already operating. In particular The Lamb Inn, Ciro's, Manhattan's nightclub**



Please see attached a map location of the premise and its surrounding neighbours highlighting residential properties as well as other clubs, pubs and bars that play music either pre recorded, live or other.

RED AREAS = OTHER BARS, PUBS, CLUBS THAT PLAY MUSIC WETHER LIVE OR RECORDED THAT EFFECT THE IMMEDIATE SURROUNDING RESIDENTS.

1. MANHATTENS NIGHTCLUB
2. THE LAMB INN
3. TAP NO.76
4. THE WHITE HART
5. THE QUEENS HEAD / CIROS NIGHTCLUB
6. THE BULLS HEAD
7. LOUNGES UK LIMITED

xxx = WE THE COMPANY, XXX BUNS LTD, APPLICANT PREMISES

BLUE AREAS = RESIDENTIAL PROPERTY'S

Objectives to prevent noise and nuisance in regards to local residents / neighbours.

1. **GLASS WASTE**
  - ANY / ALL GLASS WASTE WILL BE EMPTIED BEFORE THE HOURS OF 23:30 TO REDUCE THE TRAVELLING OF NOISE AT NIGHT TIME.
2. **MUSIC AMPLIFIED / UAMPLIFIED**

- ANY MUSIC THAT IS PLAYED ON THE PREMISE WILL BE PLAYED WITHIN THE RESPECTS OF LOCAL RESIDENTS AND NEIGHBOURS, ENSURING NOTHING CAN BE HEARD FROM THE PREMISE.
- MUSIC WILL PLAYED OUTSIDE (ON THE BALCONY AREA) WILL NEVER EXCEED 60 DECIBELS. (Standard conversation levels).
- BEING A RESTAURANT, MUSIC WILL BE PLAYED AT AN AMBIENT LEVEL AND WILL NOT DISTURB ANY SURROUNDING RESIDENCE.

3. **VOICE LEVELS**

- ANY PERSONS SHOUTING, SCREAMING OR BEING LOUD IN GENERAL WILL BE REMINDED BY DOOR SUPERVISORS OR OTHER TRAINED STAFF TO LOWER THE VOLUME. IF THE PERSONS PERSIST THEY WILL BE REMOVED AND REPORTED VIA PUB WATCH SCHEME OR TO LOCAL AUTHORITIES.
- VISIBLE SIGNAGE REQUESTING RESPECT FOR OUR NEIGHBOURS IN REGARDS TO NOISE LEVELS / DISTURBANCE.

4. **NUISANCE SMELLS**

- ALL WASTE WILL BE BAGGED AND TIED WITH REFUSE SACKS AND DISPOSED OF IMMEDIATELY FROM THE PREMISE TO AVOID BUILD UP OF ANY NUISANCE SMELLS.
- WASTE PLACED INTO OUTSIDE BINS WILL ALWAYS BE DOUBLE CHECKED TO BE SHUT.

5. **NUISANCE LIGHTING**

- ANY LIGHTS ON THE EXTERIOR OF THE PREMISE WETHER SIGNAGE, BALCONY LIGHTS OR OTHER SHALL NOT BE SO BRIGHT TO VISIBLY CAUSE STRESS OR NUISANCE TO ANY RESIDENTIAL PROPERTIES IN THE IMMEDIATE AREA.

\*A VIDEO REPRESENTATION OF SOUND LEVELS CAN BE PROVIDED.

**CONCERN #4 PREVENTION OF HARM AGAINST CHILDREN**

Representations made -

There is a gym/boxing club situated on Bakery Court directly next door to these premises that provides exercise and training for children of all ages, many of whom gather outside the gym, beside the application premises outside balcony, before and after their training sessions. The Committee is concerned that children using gym will be subject to inappropriate comments & language from intoxicated customers of XXX Buns Ltd with the possibility of more severe harm.

**ADDRESS #4 PREVENTION OF HARM AGAINST CHILDREN**

**“Although it is the licensee’s duties to ensure the safety of public and protection for children against harm it is not the licensee’s responsibility to supervise another business’s attendee’s and therefore down to the gym owner to provide a safe space(s) for children to be picked up / dropped off from by parents in regards to the children classes mentioned.**

**Whether before or after their training sessions it is also down to the gym owner to ensure that no child / attendee loiters outside or uses another business terrace as a 'climbing frame' or 'chill spot' out of respect for their neighbours and ensure they are collected by a parent/guardian accordingly.**

**That being said, it has been agreed upon by the gym owner himself and I, that he has no concern or objections regarding our application for a new premise licence.**

**This is simply down to, we plan to operate at times when the children's classes do not. (Please see current operating times below in red).**

**The idea that children will be exposed to any/more illicit material whether verbal or physical and more severe harm is groundless and can be applied or said to every and all pubs/restaurants that provision the sale of alcohol."**

### **MOTIV 8 KID'S CLASSES**

MONDAY, TUESDAY, THURSDAY, SATURDAY'S.

45 MINUTE SESSIONS

4:00PM, 4:45PM, 5:30PM.

SATURDAYS 11AM.

### **XXX BUNS LTD CURRENT OPERATING SCHEDULE**

TUESDAY - FRIDAY 5:00PM - 23:00PM

SATURDAY 2:00PM - 23:00PM

SUNDAY 4:00PM - 23:00PM

### **XXX BUNS SERVICE HOURS**

TUESDAY - FRIDAY 5:30 - 22:30PM

SATURDAY 2:00 - 22:30PM

SUNDAY 4:00 - 22:30PM

The above is reference to see we (XXX BUNS LTD) do not operate during the hours of the children's classes as agreed upon by the gym owner himself. Further more please refer to the objectives to receive clarification in regards to safety of children.

Objectives for the prevention of children against harm.

#### **1. CCTV**

- CLOSED NETWORK CCTV WILL OPERATE 24/7 COVERING ALL ANGLES OF THE INTERIOR AND EXTERIOR OF THE PREMISE.

- CCTV WILL RECORD DAILY FOR THE PURPOSE OF BEING ABLE TO GO BACK TO A SPECIFIC EVENT IF NEEDED AND BE HELD ON THE PREMISE FOR UP TO 30 DAYS.
- IF NEEDED, AT ANY POINT THE LOCAL AUTHORITIES CAN AND WILL BE GIVEN ACCESS TO THE CCTV FOOTAGE.
- CCTV WILL OPERATE IN CLEAR LIGHT, COLOUR & SOUND.
- CCTV CAMERA'S WILL BE ANGLED TO EASILY CAPTURE A PERSONS PROFILE AND FACE.

## 2. **DOOR SUPERVISORS**

- ACCREDITED & CERTIFIED DOOR SUPERVISORS WILL HIRED FOR THE DUTIES OF ENSURING SAFE CONDUCT WITHIN / OFF THE SURROUNDING PREMISE.
- DOOR SUPERVISORS WILL ENSURE ANY/ALL GLASSES ARE KEPT ON THE PREMISE.
- DOOR SUPERVISORS WILL ENSURE ALL ATTENDEES ARE CHALLENGED USING THE THE CHALLENGE 25 SCHEME
- DOOR SUPERVISORS WILL ENSURE THE REFUSAL OF ANY DRUNKEN PERSONS.
- DOOR SUPERVISORS TO BE TRAINED IN THE SAFE DEESCALATION OF SITUATIONS.
- DOOR SUPERVISORS WILL ENSURE EVERY PERSON IS FREE FROM ILLICIT DRUGS / WEAPONS. PERSONS CAUGHT WITH ANY ILLICIT DRUGS / WEAPONS WILL HAVE THEM IMMEDIATELY CONFISCATED AND PLACED INTO A LOCK SAFE & THE PERSONS WILL BE REPORTED TO AUTHORITIES. UNTIL THE AUTHORITIES ARRIVE TO SAFELY DISPOSE AND DEAL WITH SITUATION.
- DOOR SUPERVISORS WILL BE IN ATTENDANCE ON THE PREMISE DURING OPENING HOURS ACCORDING TO THE CONFIRMED OPERATING SCHEDULE.

## 3. **OPERATING TIMES**

- THE LICENSEE SHALL AGREE UPON WITH THE OWNER (LIAM PARKER) OF THE NEIGHBOURING GYM (MOTIV8), A CONFIRMED OPERATING SCHEDULE THAT BOTH PARTIES ARE HAPPY WITH IN REGARDS TO CHILDREN'S CLASSES.

## 4. **ACCESS TO THE PREMISE**

- ACCESS TO THE PREMISE WILL NOT BE GRANTED TO ANY PERSONS UNDER THE AGE OF 18. ALL PERSONS WILL BE REQUIRED TO PROVIDE PHOTOGRAPHIC GOVERNMENT ISSUED ID'S AS PART OF THE CHALLENGE 25 SCHEME.

## 5. **VERTICAL DRINKING**

- SIT DOWN CONSUMPTION OF ALCOHOL ONLY.

## 6. **NOTICES**

- NOTICES WILL BE VISIBLE ON BOTH INTERIOR AND EXTERIOR WALLS REQUIRING CUSTOMERS TO ALWAYS REMAIN IN AND LEAVE THE PREMISES IN RESPECTS OF OUR NEIGHBOURS.
- CUSTOMERS ATTENDING ON THE OUTSIDE TERRACE WILL BE VERBALLY REMINDED OF MAINTAINING NOISE LEVELS AND TO REMAIN RESPECTFUL OF OUR NEIGHBOURS.

## 7. **STAFF TRAINING**

- ALL STAFF TO RECEIVE FULL THOROUGH TRAINING IN THE FOLLOWING;

- WORKPLACE SAFETY
- SAFE HANDLING OF ALCOHOL
- CHALLENGE 25 SCHEME
- LOGGING OF ALCOHOL REFUSAL
- DEALING WITH DRUNKENNESS

- REPORTING ISSUES AS THEY HAPPEN
- RISK ASSESSING / RISK MANAGEMENT

ALL STAFF TRAINING SHALL BE RECORDED AND KEPT LOGGED ON SITE

CONCERN #5 SUGGESTIONS TO LICENCE

<p><b>Please suggest any conditions that could be added to the licence to remedy your representation or other suggestions you would like the Licensing Sub Committee to take into account.</b></p>	<p>Limit alcohol licence to daytime only.</p>
--	---

“As an evening business, (other than a saturday) not only would it make no sense to only allow for a day time licence but rather contradictory to the concerns mentioned previously as this will cause us the company to have to operate at times when the children’s classes run in the gym located next door. If any ammendments are to be considered I would argue that we be granted a licence from 17:00pm until Midnight as there is no presence of children of any ages within those hours.”

\*PLEASE ALSO DO NOT HESITATE TO CONTACT ME FURTHER WITH ANY CONCERNS WITH REGARDS TO THE APPLICATION AND I WILL BE MORE THAN HAPPY TO PROVIDE ALL INFORMATION / DOCUMENTATION YOU MAY NEED TO ASSIST IN THE DECISION MAKING FOR THE APPLICATION.

Many Thanks,

Anthony Haslam

Director

XXX BUNS LTD

ADMIN@XXXBUNSLTD.CO.UK

01530648074

COMPANY NO. 14750247

**CONFIDENTIALITY AND DISCLAIMER (GWP)**

This Document and any attachments are private and confidential.

You must not disclose, distribute, copy or print this document if you are not the intended addressee.

If you have received this document in error then please inform the sender immediately and delete from your system.